

1/8" - 1/16" PNEUMATIC VALVE

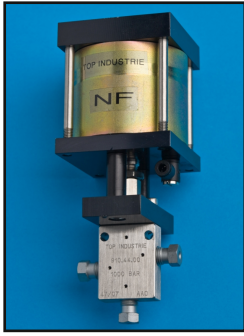

USES :

TOP INDUSTRIE 1/8" and 1/16" pneumatic valves work for pressures up to 1000 bar. They are highly reliable and known for their perfect sealing. TOP INDUSTRIE valves set the standards in the high pressure industry.

FEATURES :

- Works at pressures between 0 and 1000 bar
- Separate guide for stem and actuator.
- Material : 1.4571 (316 Ti)
- HP Tubing : 1/8" ou 1/16"
- Maximum temperature : 100° C/212 F
- Suitable for both liquids and gases.
- HP connection : gland nut
- Metal to Metal sealing.
- Normally Open valve (NO)
- Normally Closed valve (NC)

- Weepers for leak detection .

- All our valves are equipped with collars or gland nuts.
- Orifice diameter 1mm or 1,5mm

OTHER OPTIONS :

- Alternative materials: Hastelloy B2, C276, Titanium, etc.
- Limit switches
- Maximum temperatures of up to 300° C using a graphite joint.
- Stellite stem in case of heavy duty usage
- ATEX on demand

PRESSURE	TUBE HP Ø EXT.		TYPE	WHEIGHT	REFERENCE Orifice Ø 1 mm		REFERENCE Orifice Ø 1.5 mm	
	bar / psi	inch			mm	gr	normally open	normally closed
1000 14500	1/8"	3,2	1	1020	910 13 00	910 14 00	917 13 00	917 14 00
			2	1030	910 23 00	910 24 00	917 23 00	917 24 00
			3	1030	910 33 00	910 34 00	917 33 00	917 34 00
			4	1040	910 43 00	910 44 00	917 43 00	917 44 00
			5	1980	910 53 00	910 54 00	917 53 00	917 54 00
1000 14500	1/16"	1,6	1	1020	110 13 00	110 14 00	117 13 00	117 14 00
			2	1030	110 23 00	110 24 00	117 23 00	117 24 00
			3	1030	110 33 00	110 34 00	117 33 00	117 34 00
			4	1040	110 43 00	110 44 00	117 43 00	117 44 00
			5	1980	110 53 00	110 54 00	117 53 00	117 54 00

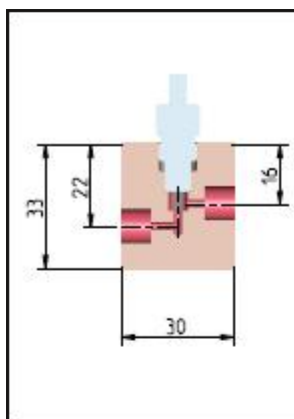

TYPE 1

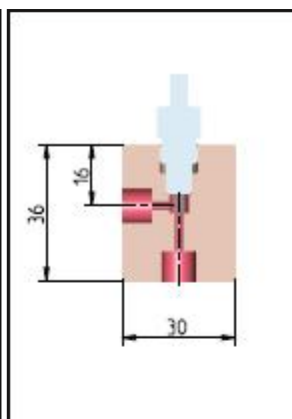

TYPE 2

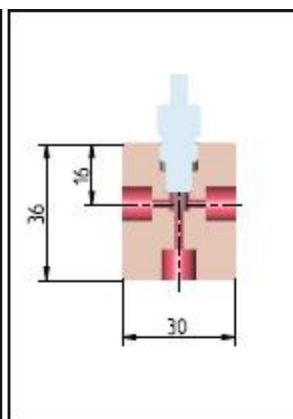

TYPE 3

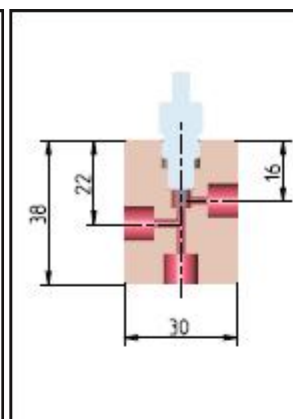

TYPE 4

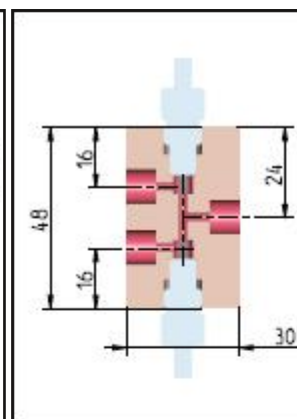

TYPE 5



1/8" - 1/16" PNEUMATIC VALVE

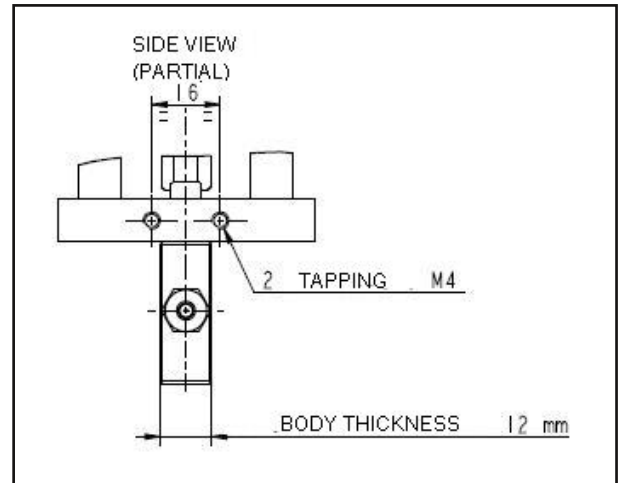
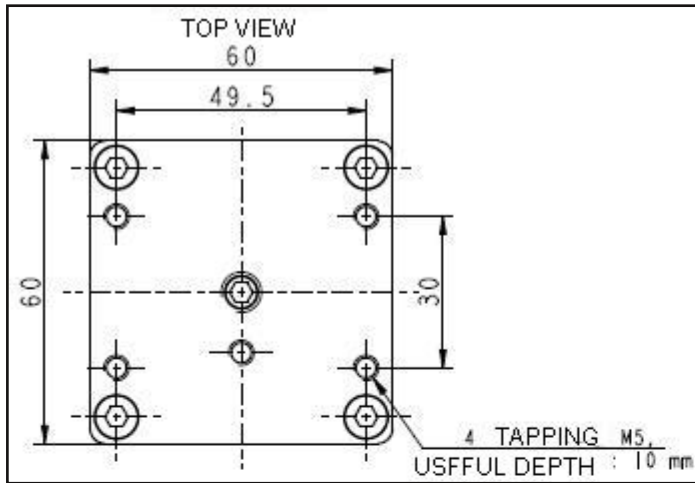

Tube mounting : See technical info (B4F)

Air pressure : mini 5 bar (pour NF)
maxi 7 bar

Air connection : Banjo connection M5 delivered with valve , tube size 4 x 2

OPTIONS :

- Bracket : ref 910 14 18
- Plate switch : ref 910 14 25
- Inductive limit switches : ref 910 14 29

SPARE PARTS	KEY	NAME	REFERENCE	MATERIAL
	3	STEM	910 14 12	1. 4542
	8	PACKING BOX	910 14 13	1.4305
	9	FLANGE	910 14 08	ALUMINIUM
	10	SCREW CHC M4	910 14 20	STAINLESS STEEL
	11	LOWER COLLAR	910 14 09	STAINLESS STEEL
	12	NUT M8	910 14 10	STAINLESS STEEL
	13	CONTACT PLATE	910 14 25	ALUMINIUM
	14	BRIDE	910 14 02	ALUMINIUM
	15	GASKET	910 14 22	NITRILE
	16	GASKET	910 14 17	TEFLON
	17	DRIVE STEM NF	910 14 07	STAINLESS STEEL
	17	DRIVE STEM NO	910 13 07	STAINLESS STEEL
	18	JOINT	910 14 21	NITRILE
	19	NUT M5	910 14 15	STAINLESS STEEL
	20	NF SPRING	910 14 14	STEEL
	20	NO SPRING	910 13 14	STEEL
	21	PISTON	910 14 04	ALUMINIUM
	22	TUBE	910 14 03	STAINLESS STEEL
	23	WASHER	910 14 05	ALUMINIUM
	24	FLANGE	910 14 01	ALUMINIUM
	25	NIPPLE M8	910 14 06	STAINLESS STEEL
	26	SPACER	910 14 11	ALUMINIUM
	27	SCREW CHC M5	910 14 19	STAINLESS STEEL
	28	BANJO FITTING	910 14 26	

* For 1, 2, 4, 5, 6 and 7: lookup spare parts of manual valve (A1)

In view of possible technological advances in our production methods, the products described in this manual are liable to be modified without prior notice.



TOP INDUSTRIE
High Pressure Engineering

A2A